

# NEW HAVEN CITY PLAN COMMISSION ADVISORY REPORT

**RE:** 743 WINCHESTER AVENUE, (MBP 254-0490-03400) Land Disposition Agreement of Sliver Lot [NHS].  
**REPORT:** 1473-07  
**ADVICE:** Approval

## PROJECT SUMMARY:

---

**Developer:** Neighborhood Housing Services of New Haven, Inc.  
**Disposition Price:** \$2,613.00  
**Site:** 2,700 S.F.  
**Zone:** RM-2  
**Use:** Additional Land  
**Financing:** Private  
**Subsidy:** None  
**City Lead:** Evan Trachten  
**Agency:** Livable City Initiative  
**Phone:** 946-8373

## BACKGROUND:

The City acquired this parcel and proposes to sell it to Neighborhood Housing Services (NHS) who will maintain the parcel in conjunction with their adjoining lot known as 745-749 Winchester Avenue. NHS plans to renovate 745 Winchester and the added sliver lot will accommodate the parking requirement off street. A recent site visit shows the subject property bounded by Bassett and Huntington Streets within the Newhallville neighborhood. The lot is vacant; however, a stockade fence buffers the lot at the street front.

## Prior CPC Action:

- Approved with Conditions (CPC file# 1087-06) Land Disposition Agreement (LDA) for Infill Housing (CUHO) March, 1989. The LDA was not executed.

## PLANNING CONSIDERATIONS:

As planned the City will divide the existing non-conforming lot and sell each half to the abutting property owners as additional usable land. Evaluation of the site was based on examination of the City Tax Map and a site visit as a survey was not submitted. The City proposes to sell the sliver parcel for \$2,613.00 and the estimated cost of improvements is unknown. The Commission has not addressed the issue of price.

## ADVICE:

The Commission finds the proposed reuse of the property suitable for the site in question and therefore recommends approval.

**ADOPTED:** January 16, 2013  
Edward Mattison  
Chair

**ATTEST:**   
Karyn M. Gilvarg A.I.A.  
Executive Director

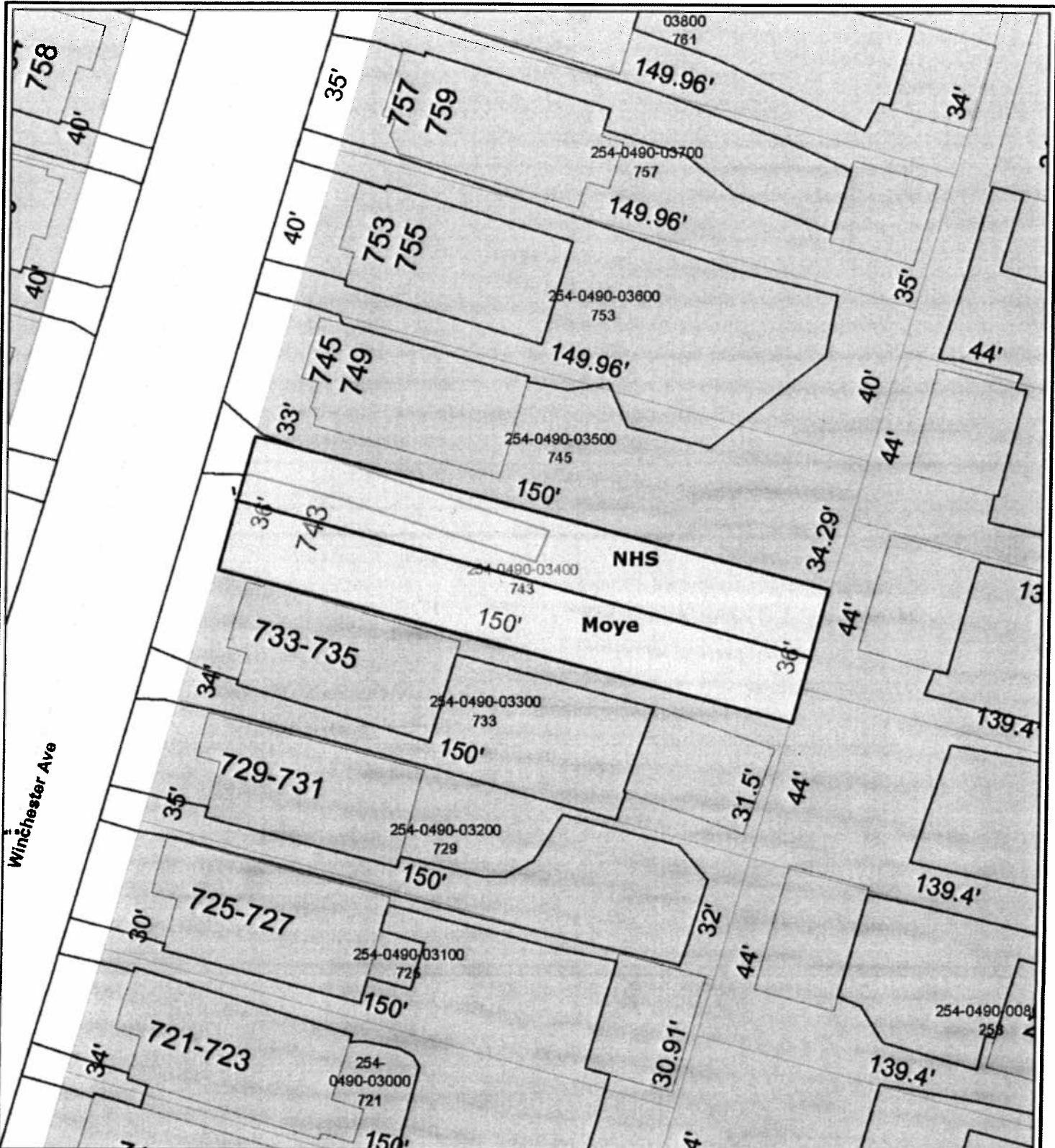

City of New Haven, Connecticut  
John DeStefano Jr., Mayor



**743 Winchester Ave. - CPC 1473-06 & 07**

Produced by the  
Office of Information Technology  
Geographic Data Viewer

- Waterway
  - Lake - Pond
  - River
  - Shoreline
  - Stream
  - Wetland
- Parcel
  - City Boundary Line
- Schools
  - Administration
  - Food Service
  - Private School
  - Public School
- Fire Station
- Police Station
  - PD Headquarters
  - Substation
- Health Centers
- Hospital
- Library
- Railroad
  - Railroad Track
  - Abandoned Railroad Track
- Airport Runway
- Parcel Line\_2005
- Parks
  - Park
  - Triangle
  - Golf Course
  - Land Trust Preserves
  - Airport boundary
  - Shoreline

This map is intended for illustrative and Community-Based Planning processes. Every reasonable effort has been made to assure the accuracy of the map and data provided; nevertheless, some information may not be accurate. The City of New Haven assumes no responsibility arising from the use of this information.

No warranty is made by the City of New Haven as to the accuracy, reliability or completeness of these data for individual or aggregate use with other data. Original data compiled from various sources. Spatial information may not meet national map accuracy standards. This information may be updated without notification.

Scale: 1" = 35 ft

Created: January 8, 2013

